



DAV PUBLIC SCHOOL, JAMUI
(Managed By- DAV College Managing Committee, New Delhi-55)
Phone No. :06345 224272 Email Id : dav_jamui@rediffmail.com

Ref. No. : DAV/Ps/Jamui/2025-26/TENDER

12/02/2026

**TENDER NOTICE FOR CONSTRUCTION OF COMPOSITE LAB IN
UPPER HALL(THIRD FLOOR) OF SCHOOL**

Tender in closed and sealed envelop is invited from eligible firm for the following:-

The eligibility and other details are as follows:

Eligibility & Other Information:

- 1) The bidders should be an Indian Firm engaged in civil work and Registered as per existing norms from Government Department.
- 2) They should have minimum three years of experience in the field and worked with Govt. Depts./PSUs/MNCs/etc.
- 3) They should not have been blacklisted by the Departments/Ministries of the Govt. of India Declaration to this effect is to be submitted.
- 4) For bidding , the firms are required to submit the following self- attested and duly rubber stamped (on each page) photocopies of the following documents relating to their printing press/firm:
 - (a) Registration Certificate as per existing norms from Government Department ;
 - (b) Copy of GST Registration Certificates;
 - (c) Copy of latest GST return
 - (d) Copy of PAN Card
 - (e) Declaration regarding blacklisting
- 5) The rate should be quoted in Indian Rupees (in both words and figures) only.
- 6) Tender in a **CLOSED & SEALED ENVELOPE** should be addressed to –
THE PRINCIPAL, DAV PUBLIC SCHOOL
ASHOK TOWN HALL ROAD, JAMUI, BIHAR, PIN CODE -811307
and must reach on or before **25/02/26 ; 17:00 hrs.**
Note: Tender in a closed and sealed enveloped must be sent through Registered Post/ Courier or can be submitted by hand.
- 7) Tenders will be opened at 3:00 PM on 27th February at BR DAV PUBLIC SCHOOL, IOCL REFINERY TOWNSHIP, BEGUSARAI, BIHAR and all bidders are requested to be present.
- 8) The basic rates of major items such as glazed tiles, granite stone, electrical fixtures etc. shall be clearly mentioned in tender documents along with item numbers, brand names, model numbers and technical specifications..
- 9) In the event of failure on the part of work by the Bidder /Firm, the rest work may get completed from another firm and the previously engaged bidder/firm will have to reimburse the extra expenditure incurred thereafter.
- 10) **Process of construction should be as per BOQ and Drawing enclosed herewith.**
- 11) Payment against Bill /Invoice shall be released only after completion of the work to the satisfaction of the architect & competent committee. No interest will be payable on the delayed payments. Payment will be made directly to the firm through Multi-city cheque only. No request for other mode of payment will be entertained..
No advance payment will be made in any case. However part payment can be done on satisfaction of Architect.
- 12) The Tenderer will be bound by the details furnished by him/her while submitting the tender or at subsequent stage. In case, any of such documents furnished by him/her found to be fictitious at any stage, it would be deemed to be a breach of terms of contract making him/her liable for **legal action besides termination of the contract.**
- 13) No charges such as Octroi, packing, forwarding, freight insurance, loading and unloading, entry tax, demo, etc. will be allowed. All these are to be borne by the bidder only.
- 14) The Tenderer is not bound to accept the lowest bidder rather he/she is free to accept the bid on the basis of experience and technical viability.
- 15) This office has right to amend any T&C listed in the documents as per the changes notified by the Govt. and has right to add or delete any Para for quality management of the work.

MRINAL KANT

D.A.V. PUBLIC SCHOOL, SR. BRANCH, ASHOK TOWN HALL ROAD, JAMUI, BIHAR
PH-06345-224272; MOB-9431468660; E-MAIL-dav_jamui@rediffmail.com

REF:-DAV-JM/SB/CL/01/25-26

Date:- 3 JAN. 2026

BILL OF QUANTITY

COMPOSITE LAB AT THIRD FLOOR OF D.A.V. PUBLIC SCHOOL, SR. BRANCH, JAMUI, BIHAR.

Sl.No.	S.O.R.	DESCRIPTION	Qty.	Unit.	Rate	Amount
(1) COMPOSITE LAB						
		Area of Composite lab = 34'-10"X53'-5"+3'-6"x1'-0" = 1864.12 Sft (173.25 Sqm)				
		SECTION-I (FINISHING WORK)				
1	13.80A.2	Providing and applying white cement based putty of average thickness 2 mm of approved brand and manufacture, over the plastered wall surface to prepare the surface even and smooth, complete.	357.58	Sqm		
2	13.81A	Distempering with 1st quality acrylic distemper, having VOC (Volatile Organic Compound) content less than 50 grams/litre, of approved brand and manufacture, including applying additional coats wherever required to achieve even shade and colour.				
	13.81.2B	Two coats	357.58	Sqm		
3	13.74	Removing white or colour wash by scrapping and sand paper in and preparing the surface smooth including necessary repair scratches etc. complete.	357.58	Sqm		
4	13.82	Painting with ready mixed paint of approved brand and manufacture in all shades to give an even shade.				
	13.82.3	Old steel work (one or more coats.)	31.39	Sqm		
	13.82.4	Old wood work (one or more coats.)	5.29	Sqm		
		SECTION-II (CARPENTRY,STEEL,HARDWARE)				
5	9.43	Providing and fixing 18 mm thick, 150 mm wide pelmet of coir veneer board ISI marked IS: 14842, including top cover of 6mm coir veneer board, nickel plated M.S. Pipe 20 mm dia, (heavy type) curtain rod with nickel plated brackets, including fixing with 25x3 mm M.S. Flat 10 cm long fixed to pelmet with hollock wood cleats of size 100 mm x 40 mm on both inner side of pelmet and raw plugs 75 mm long etc. all complete.	33.38	M		
6	9.44	Extra for using veneered particle board conforming to IS: 3097 Grade I, in item of pelmet 18 mm thick 150 mm wide.				
	9.44.2	Particle board with decorative veneering on both sides.	33.38	M		
7	9.101	Providing and fixing aluminium hanging floor door stopper, ISI marked, anodised (anodic coating not less than grade AC 10 as per IS 1868) transparent or dyed				

Sl.No.	S.O.R.	DESCRIPTION	Qty.	Unit.	Rate	Amount
		to required colour and shade with necessary screws etc. complete.				
	9.101.2	Twin rubber stopper.	2	No.		
8	9.83	Providing and fixing aluminium die cast body tubular type universal hydraulic door closer (having brand logo with ISI, IS: 3564, embossed on the body, door weight upto 35 kg and door width upto 700 mm), with necessary accessories and screws etc. complete.	2	No		
		SECTION-III (ALUMINIUM WORK)				
9	MR	Providing and fixing aluminium framed doors, sliding windows, ventilators and partitions with Aluminium sections, 4 mm thick plain glass, rubber, handles, door bolts, sliding tower bolts and locks, composite panel etc. complete.	116.28	Sqm		
		SECTION- IV (FLOORING WORK)				
10	11.36	Providing and fixing first quality ceramic glazed wall tiles confirming to IS 15622(Thickness to be specified by manufacturer) of approved make in all colours, shades except burgundy, bottle green, black of any size as approved by engineer in charge in skirting, risers of steps and dados over 12mm thick bed of cement mortar 1:3 (1 cement, 3 coarse sand) and jointed with grey cement slurry @ 3.3 Kg/sqm including pointing in white cement mixed with pigment of matching shade complete.	41.00	Sqm		
		SECTION - V (ELECTRICAL WORK)				
11	1.1	Wiring for light point/fan point/exhaust fan point/ call bell point with 1.5 sq.mm FR PVC insulated copper conductor single core cable in surface/recessed medium class PVC conduit with piano type switch, phenolic laminated sheet, suitable size M.S./PVC box etc. as required.				
	1.1.3	Group 'A'	21.00	Point		
		SECTION - VI (WOOD WORK)				
12	9.169	Providing and fixing 19 mm thick both side balancing lamination factory pressed BWP grade marine ply as per IS 710 of approved brand boxes, shelves, racks, almirah, cupboard and drawer etc. including necessary nails,screws etc. complete as per direction of Engineer -in- charge.	179.93	Sqm		
13	9.174	Providing and fixing 2mm thick 16 to 19 mm wide PVC edge binding tape of approved quality for cupboard/ wardrobe shutters including necessary synthetic resin hot pressed to edges on binding machine etc. compl-				

Sl.No.	S.O.R.	DESCRIPTION	Qty.	Unit.	Rate	Amount
		ete as per direction of engineer-in-charge.	176.17	Rm		
14	9.115	Providing and fixing powder coated telescopic drawer channels 300 mm long with necessary screws etc. complete as per direction of Engineer-in-charge.	2	Each set		
		SECTION- VII (SANITARY WORK)				
15	17.7	Providing and fixing wash basin with C.I. brackets 15 mm C.P. brass pillar taps, 32 mm C.P. brass waste of standard pattern including painting of fittings and brackets, cutting and making good the walls wherever required:				
	17.7.7	White Vitreous china Flat back wash basin size 450x 300 mm with single 15 mm C.P. brass pillar tap.	4	Each		
16	17.29	Providing and fixing 100 mm sand cast iron grating for gully trap.	4	Each		
17	17.71	Providing and fixing PTMT liquid soap container 109 mm wide, 125mm high and 112mm distance from wall of standard shape with bracket of the same materials with snap fittings of approved quality and colour, weighing not less than 105 gms.	4	No.		
18	17.73	Providing and fixing PTMT towel ring complete with brackets fixed to wooden cleats with CP brass screws with concealed fittings arrangement of approved quality and colour.				
	17.73.1	450 mm long towel rail with total length of 495 mm, 78 mm wide and effective height of 88 mm, weighing not less than 170 gms.	4	No.		
		SECTION - VIII (MISCELLANEOUS WORK)				
19	MR	Providing and fixing steel revolving chairs etc. complete as per direction of Engineer-in-charge.	70	Each		
20	MR	Providing and fixing vertical blinds in windows etc. complete as per direction of Engineer-in-charge.	13	Each		
		SECTION - IX (DISMANTLING WORK)				
21	14.83	Hacking of CC flooring including cleaning for surface etc. complete as per direction of Engineer-in-charge.	41.00	Sqm		
		SUB TOTAL				
		Add 1% extra for external and internal PHE work, external and internal electrical works.				
		TOTAL				
		ROUNDUP				
		Cost of construction per sq. ft.				

AREA OF COMPOSITE LAB = $34'-10" \times 53'-5" + 3'-6" \times 1'-0" = 1864.12 \text{ SFT}$

MD = $3'-6" \times 7'-9"$ WOODEN DOOR + AL. DOOR GLAZED
W = $6'-0" \times 4'-4"$ M.S. GLAZED + AL. SLIDING GLAZED
D = $3'-0" \times 7'-0"$ AL. DOOR

15 AMP. SOCKET

VITRIFIED FLOOR & 6" SKIRTING IS EXISTING.
WALL TILES UP TO HEIGHT OF 3'-0" WILL BE FIXED IN COMPOSITE LAB. AL. WINDOW SLIDING & DOOR WILL BE FIXED IN LAB. ALUMINIUM PARTITION IN 8'-0" HT. WILL BE FIXED IN STORE ROOM & TEACHER ROOM.
DISTEMPER PAINTING WITH PUTTY 2 COATS WILL BE DONE ON WALL & CEILING. DOOR & WINDOWS WILL BE PAINTED.
2'-0" WIDE BOTH SIDE LAMINATED WOODEN C/B WILL BE FIXED UP TO 2'-6" HEIGHT ALONG WALL IN LAB, STORE ROOM & TEACHER ROOM. ALUMINIUM SLIDING GLASS WILL BE FIXED IN C/B & TABLES OF LAB. REVOLVING STAIN LESS STEEL CHAIR WILL BE PROVIDED FOR EACH STUDENT & IN STORE. ELECTRICAL & PHE WORK WILL BE DONE. POWER POINTS FOR LAB & AC WILL BE MADE. LAMINATED PELMETS WILL BE FIXED ON WINDOWS & DOOR. BLINDERS WILL BE FIXED IN WINDOWS. WASH BASINS WILL BE FIXED IN LAB. KEY BOARD AND SIDE DRAWER IN TEACHER TABLES WILL BE MADE. TABLES OF 19 MM THICK BOTH SIDE LAMINATED WITH STORAGE FACILITY FOR STUDENTS IN LAB WILL BE MADE. STORAGE UNIT OF TABLES & C/B WILL BE COVERED WITH ALUMINIUM GLAZED SLIDING.

COMPANY NAME FOR MATERIAL, FIXTURE, FITTINGS & FINISHES.

1. SANITARY FITTINGS WILL BE OF PARRYWARE/HINDUSTAN.
2. ALL PVC PIPES WILL BE OF PRINCE/SUPREME.
3. FLOOR, WALL TILES WILL BE OF KAJARIA/SOMANY/NITCO/ORIENT.
4. ALL CP FITTINGS WILL BE OF ESSCO/HINDWARE/JAGUARNAL.
5. ALL ELECTRICAL FITTINGS WILL BE OF ANCHOR/HAVELS.
6. PAINT/PRIMER WILL BE OF ASIAN/NEROLAC/BERGER/JOHNSON/BIRLA.
7. POWER POINTS WILL BE PROVIDED FOR LAB & AC.
8. ALL WORKS WILL BE MADE COMPLETELY OK.
9. GREEN LAM BOARD FOR WOOD WORK.

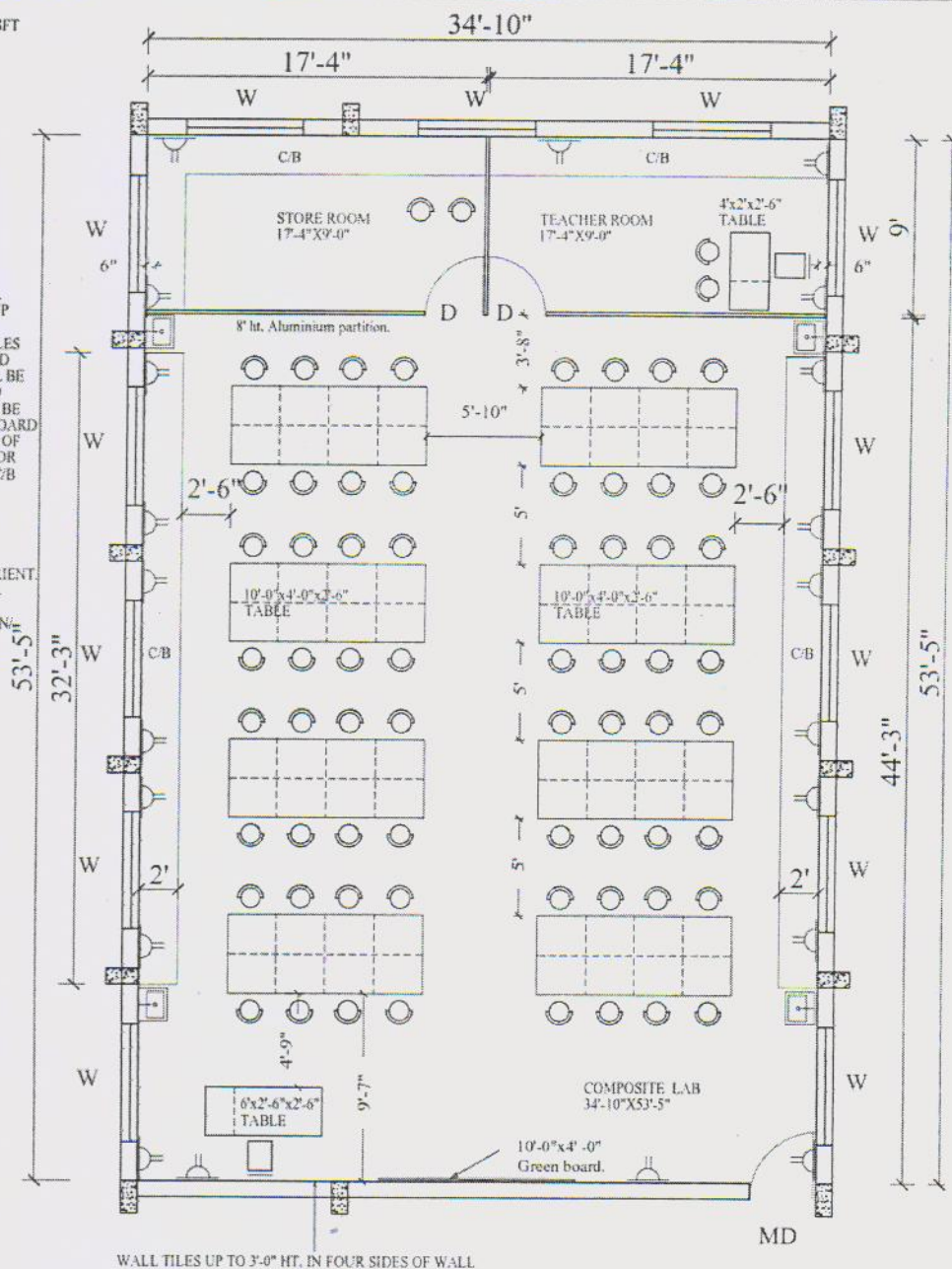

WALL TILES UP TO 3'-0" HT. IN FOUR SIDES OF WALL

PROJECT

PROPOSED COMPOSITE LAB AT THIRD FLOOR OF
D.A.V. PUBLIC SCHOOL, SR. BRANCH, JAMUI, BIHAR.

DRG. NO.-01

TITLE
COMPOSITE LAB
(3RD. FLOOR)

DATE

DEC.-25

archgroup

architects,engineers,
interior designers,
507(A),VASTU VIHAR,PH-6,
AIIMS-1,NH-139,NAUBATPUR,
ROAD,BHUSAULA DANAPUR,
PATNA-801505, M-9430001170

The following proforma of the check list need to be filled by the Tenderer Mandatorily.

1) Name and complete address of the Firm/ Company

TELEPHONE/MOBILE NO.																			
EMAIL ID																			
2) NAME OF PROPRIETER/MANAGER/CONTACT PERSON WITH CONTACT NO.																			

3) Registration No. & Date: _____

4) Certificate from Govt. Dept. (Yes/No): _____

Issuing Authority: _____

5) GST Registration No.: _____

6) Proof of last GST return (Yes/No): _____

7) PAN No.: _____

8) Proof of three years' work experience with Govt. Dept./PSU's having similar kind of work (Yes/No): _____

9) Declaration for not blacklisted by the Govt. Dept./PSU's etc. (Yes/No): _____

10) Rate of different works including GST attached. (Yes/ No): _____

I/We certify that the information furnished above is true and correct. In case, any of such information/ documents furnished by me/us are found to be fictitious, it would be deemed to be a breach of T&C and liable for legal action.

Date: _____

Name & Designation of Authorised Signatory &
seal of the firm